

FIRST FLOOR PLAN
CEILING HT. = 9'-0"

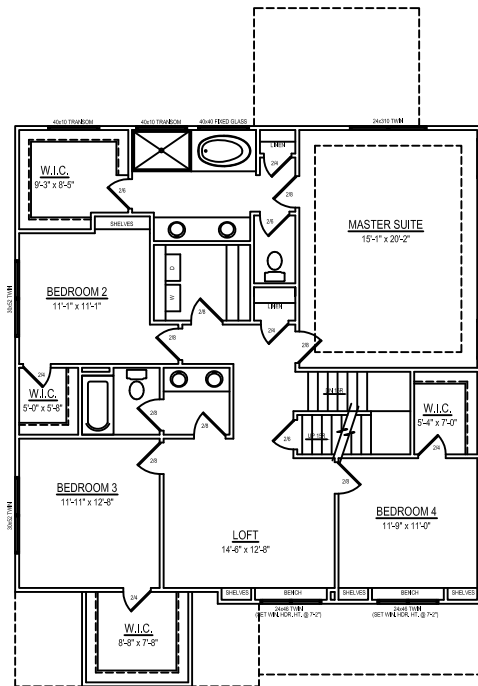

SECOND FLOOR PLAN
CEILING HT. = 9'-0"

HEATED SQUARE FOOTAGE

FIRST FLOOR =	1296	THIRD FLOOR =	N/A
SECOND FLOOR =	1583	BASEMENT =	N/A
TOTAL HEATED = 2879			

Glendale-EC